

Save: 1/18/2023 10:26 AM I:\e\l\h\h\p\l\c: 1/18/2023 10:44 AM X:\KOMM\MEQUON\168219\15-final-dsgn\51-drawings\1-Civil\cadd\dwg\sheetME168219TC.dwg

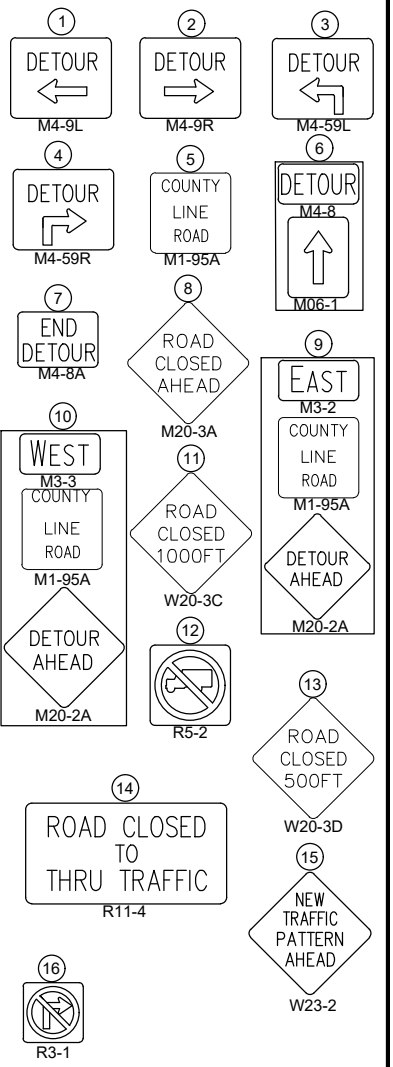
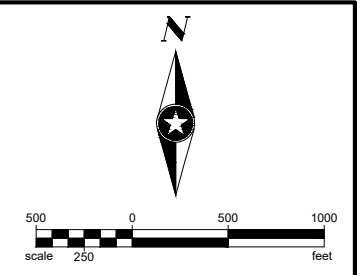
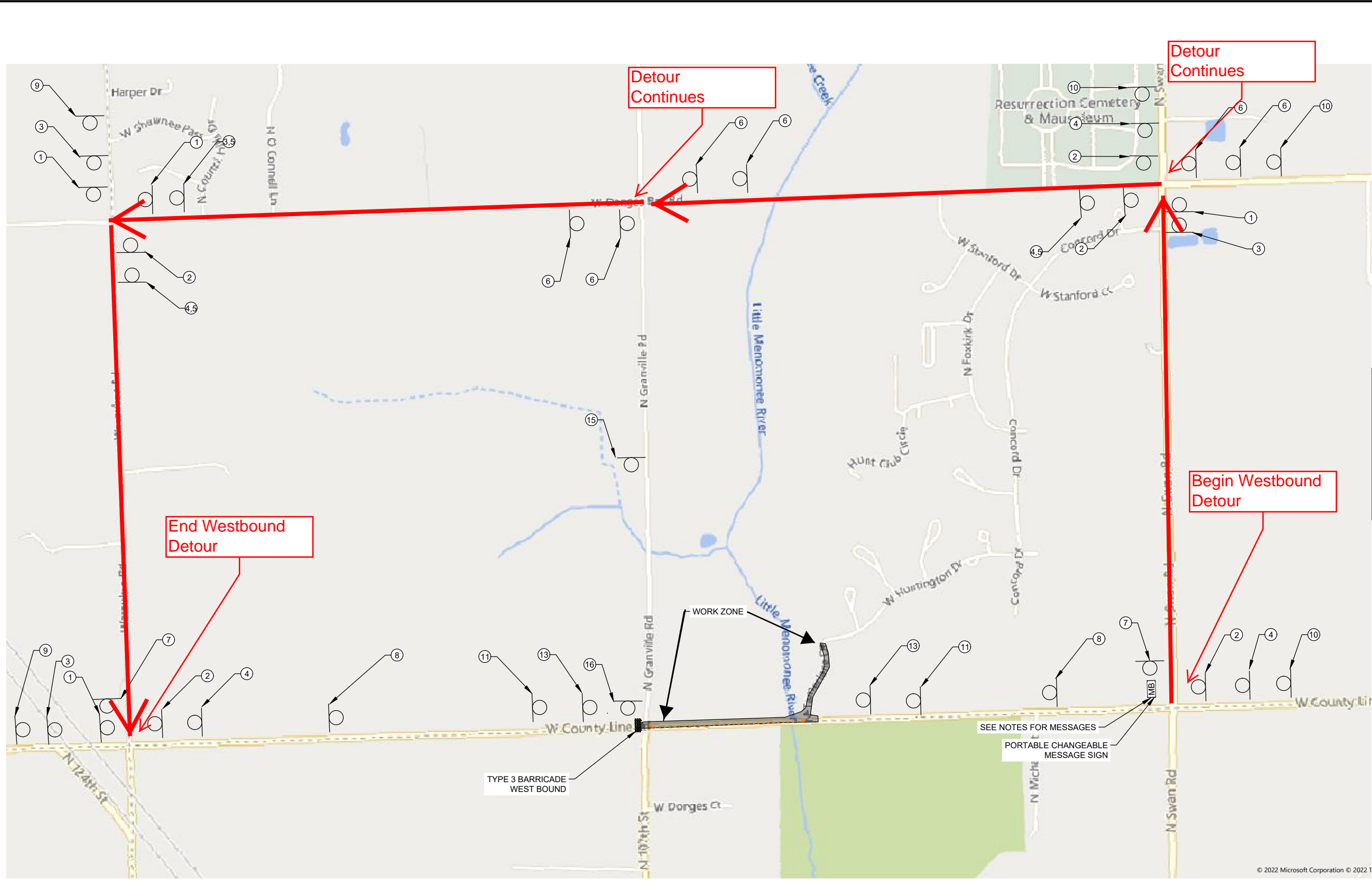

**NOTES:**  
 -MESSAGE #1 TO BE DISPLAYED FOR 5 DAYS PRIOR TO CONSTRUCTION.  
 -MESSAGE #2 TO BE DISPLAYED THROUGHOUT THE REMAINDER OF CONSTRUCTION.

**MESSAGES:**  
 #1: COUNTY LINE CLOSURE BEGINS ON (CONSTRUCTION START DATE).  
 #2: FOLLOW DETOUR SIGNS TO WAUSAUKEE RD

SEH Project	168219	Rev.#	Revision Issue Description	Date	Rev.#	Revision Issue Description	Date
Drawn By	ZJH						
Designed By	MPC						
Checked By	AB						



LIFT STATION O FORCE MAIN  
CITY OF MEQUON, WI

TRAFFIC CONTROL  
OVERVIEW & DETOUR SIGNING